



February 23, 2024, 11:15 - 2:15 p.m.

Education and Training

- 1 D.C. Everest School District
2 UW-Stevens Point - School of Education
3 Wausau School District

Architecture and Construction

- 4 UW-Stout - Construction Management
5 The Samuels Group

Science, Technology, Engineering, Math

- 6 UW-Stout - Manufacturing Engineering
7 UW-Stevens Point - Biology

Hospitality and Tourism

- 8 Northcentral Technical College - Culinary Arts
9 Wisconsin Woodchucks
10 SentryWorld

**PICK
UP
B**

South
Entrance

**Manufacturing;
Transportation, Distribution and Logistics**

- 11 Central Processing Corp/County Materials
- 12 Northcentral Technical College-Machine Tool
- 13 Schuette Metals
- 14 Greenheck Group
- 15 Crystal Finishing
- 16 Kolbe & Kolbe
- 17 CTech Manufacturing
- 18 Linetec/Wausau Windows

Agriculture, Food and Natural Resources

- 19 Monk Botanical Gardens
- 20 Wausau and Marathon County Parks,
Recreation and Forestry Department
- 21 UW-River Falls - Agriculture,
Food & Environmental Science
- 22 Wisconsin Department of
Natural Resources
- 23 UW-Stevens Point - College of
Natural Resources

West
Entrance

East
trance

**CROSS STREET
TO
SOUTH ENTRANCE
OF
UW CENTER FOR
CIVIC ENGAGEMENT**

Main
Academic
Building
Main Floor

UPSTAIRS TO LIBRARY
(SEE OTHER SIDE)

Elev.

Auditorium Sessions

11:30 a.m., 12:30 p.m.,
and 1:30 p.m.

"Finding the right college fit," followed by a panel discussion with current college students, about the college experience.

Auditorium



Wausau
UW-Stevens Point

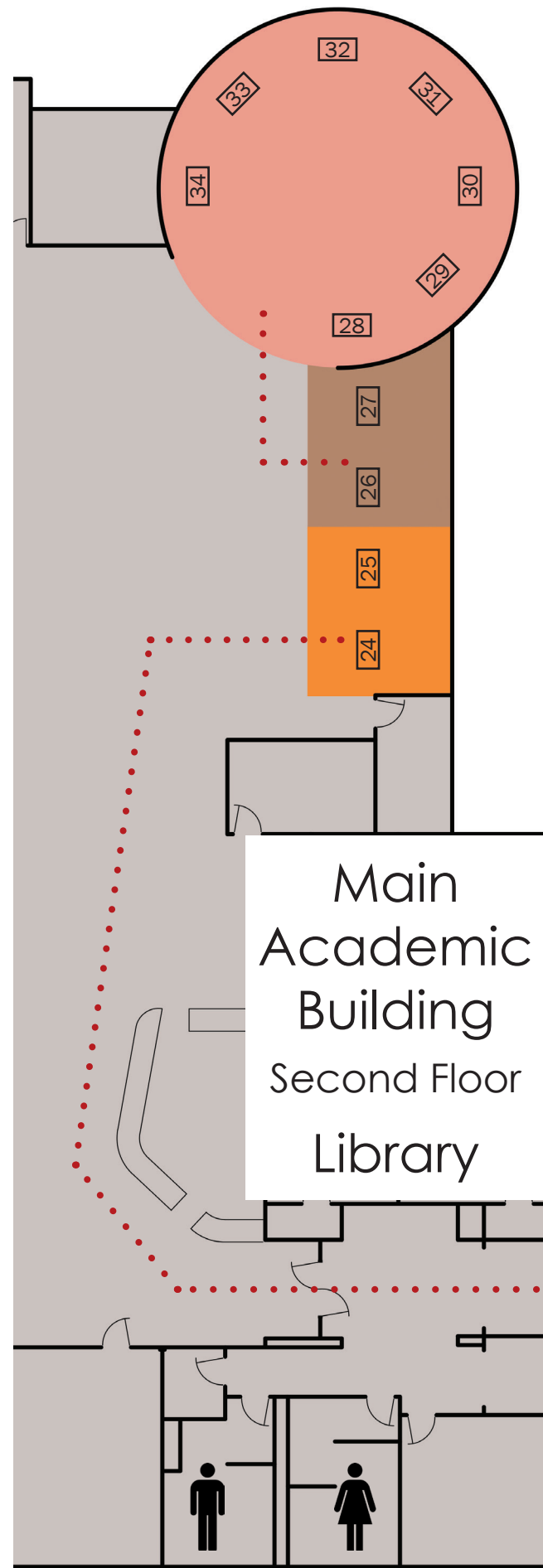

Main
Academic
Building
Second Floor
Library

- Arts, AV Technology & Communications**
 - 24 UW-Oshkosh - Radio, TV, & Film
 - 25 UW-Stevens Point - School of Art & Design, Graphic Design and Fine Art
- Information Technology**
 - 26 Skyward
 - 27 UW-Stevens Point Computing and New Media Technologies
- Finance; Marketing; Business Management and Administration**
 - 28 UW-Whitewater - Management Program
 - 29 Peoples State Bank
 - 30 Wipfli - CPAs and Consultants
 - 31 UW-Stevens Point - School of Business & Economics
 - 32 Sentry
 - 33 Northwestern Mutual
 - 34 Foundation Finance Company
- Government and Public Administration; Law, Public Safety, Corrections and Security**
 - 35 The Women's Community
 - 36 Marathon County District Attorney's Office
 - 37 Marathon County Medical Examiner's Office
 - 38 Marathon County Sheriff's Department
 - 39 Northcentral Technical College - Public Safety & Fire
 - 40 Wausau Fire Department
- Human Services**
 - 41 Boys & Girls Club of the Wausau Area
 - 42 Marathon County Social Services
 - 43 Division of Vocational Rehab
 - 44 Woodson YMCA
- Health Science**
 - 45 UW-Eau Claire at Marshfield - Nursing
 - 46 North Central Health Care
 - 47 UW-Stevens Point - Health Sciences & Wellness Programs
 - 48 Bone & Joint Clinic
 - 49 Medical College of Wisconsin
 - 50 UW-Madison - Physician Assistant

**DOWNSTAIRS TO
MAIN FLOOR
(SEE OTHER SIDE)**

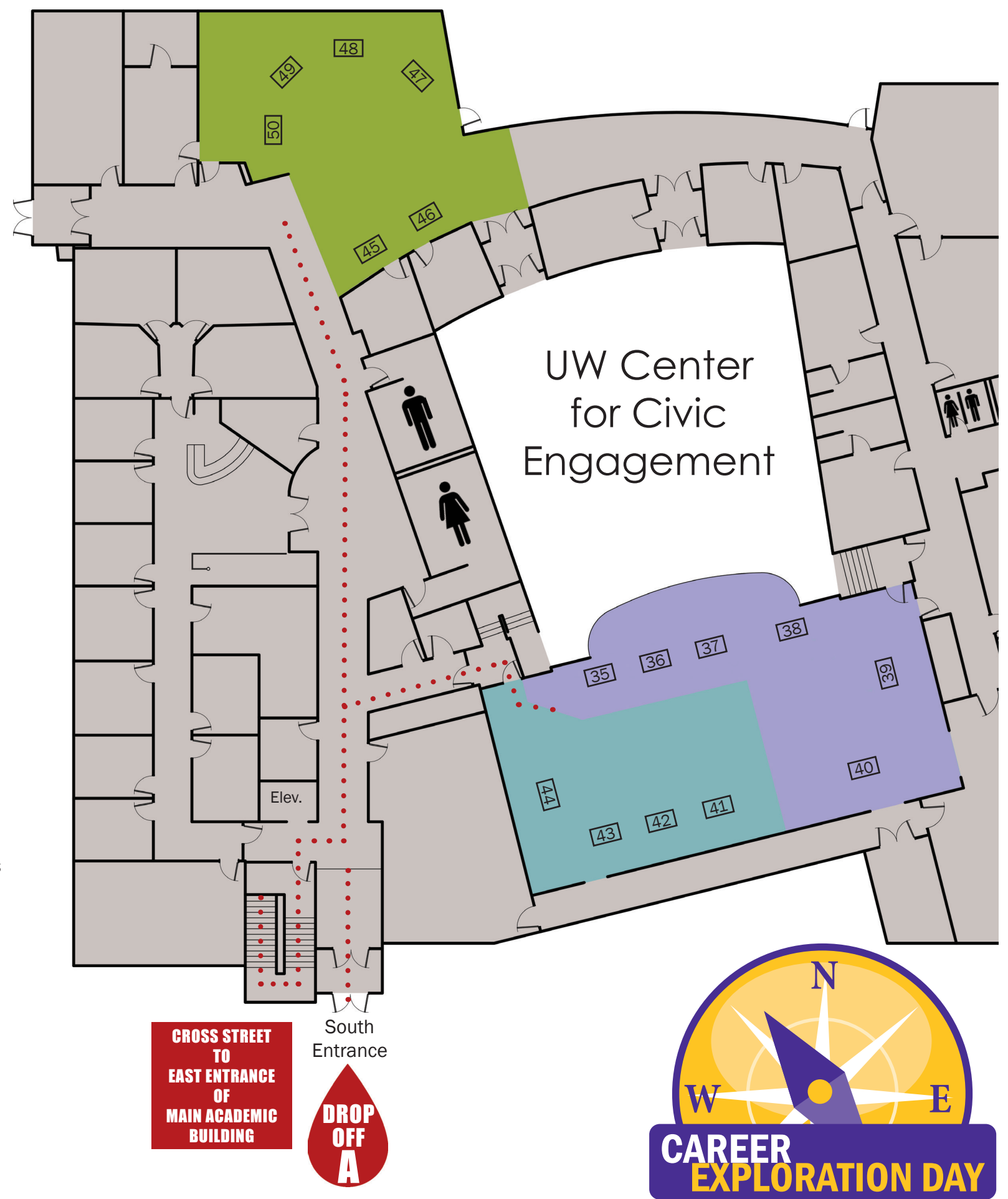

UW Center
for Civic
Engagement

**CROSS STREET TO
EAST ENTRANCE
OF
MAIN ACADEMIC
BUILDING**

South
Entrance
**DROP
OFF
A**

