

# CAREER EXPLORATION DAY

April 21, 2023, 11:15 - 2:15 p.m.

## Agriculture, Food and Natural Resources

- 1 Monk Botanical Gardens
- 2 Wausau and Marathon County Parks, Recreation and Forestry Department
- 3 UW-River Falls - Agriculture, Food & Environmental Science
- 4 Wisconsin Department of Natural Resources
- 5 UW-Stevens Point - College of Natural Resources
- 6 Raptor Education Group

## Science, Technology, Engineering, Math

- 7 UW-Platteville - Engineering
- 8 UW-Stout - Manufacturing Engineering
- 9 UW-Stevens Point - Biology, Biochemistry, and Chemistry
- 10 Chr. Hansen Inc.

## Architecture and Construction

- 11 UW-Stout - Construction Management
- 12 UW-Stevens Point - Interior Architecture & Graphic Design

## Manufacturing; Transportation, Distribution and Logistics

- 13 Schuette Metals
- 14 Northcentral Technical College - Machine Tool
- 15 Central Processing Corp/County Materials
- 16 Greenheck Group
- 17 Karl's Transport
- 18 Kolbe & Kolbe

GROUP  
A

South  
Entrance

GROUP  
C

West  
Entrance

## Hospitality and Tourism

- 19 Wausau/Central Wisconsin Convention and Visitors Bureau
- 20 Northcentral Technical College - Culinary Arts
- 21 Wisconsin Woodchucks
- 22 UW-Stout School of Hospitality Leadership

## Education and Training

- 23 D.C. Everest School District
- 24 UW-Stout - Tech Ed & Early Childhood
- 25 UW-Stevens Point - School of Education
- 26 Sentry Insurance
- 27 Wausau School District

## Auditorium Sessions

11:30 a.m., 12:30 p.m.,  
and 1:30 p.m.

"Finding the right college fit," followed by a panel discussion with current college students, about the college experience.

Main  
Academic  
Building  
Main Floor

Auditorium

UPSTAIRS TO LIBRARY  
(SEE OTHER SIDE)

Elev.

East  
Entrance

CROSS STREET  
TO  
SOUTH ENTRANCE  
OF  
UW CENTER FOR  
CIVIC ENGAGEMENT



Wausau  
UW-Stevens Point

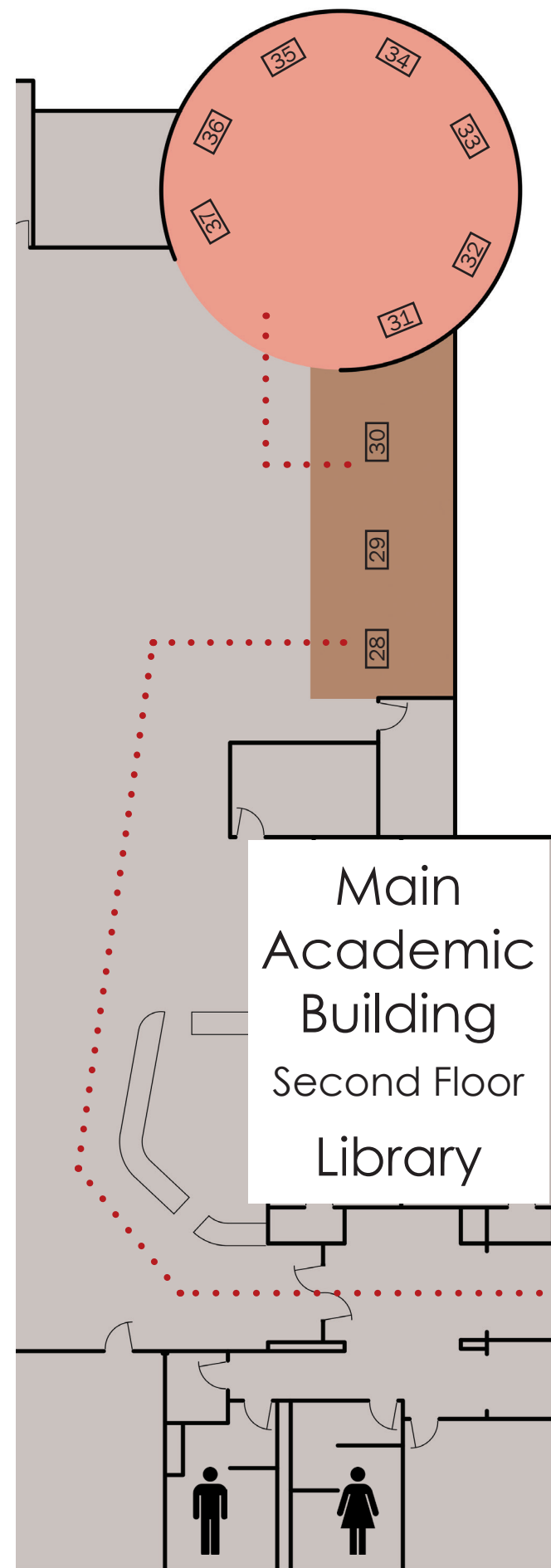

### Information Technology

- 28 Sentry Insurance
- 29 Skyward
- 30 UW-Stevens Point - Computing and New Media Technologies

### Finance; Marketing; Business Management and Administration

- 31 Marathon County Department of Employee Resources
- 32 UW-Whitewater - Management Program
- 33 Peoples State Bank
- 34 Wipfli - CPAs and Consultants
- 35 UW-Stevens Point - School of Business & Economics
- 36 Sentry Insurance
- 37 Northwestern Mutual

### Human Services

- 38 UW-Stevens Point - Social Work & Psychology
- 39 UW-Stout - Vocational Rehabilitation
- 40 Boys & Girls Club of Wausau
- 41 Marathon County Social Services
- 42 UW-LaCrosse - Recreation Mgmt. & Therapeutic Rec.
- 43 United Way Emerging Leaders

### Health Science

- 44 Bone & Joint Clinic
- 45 Aspirus Health Care
- 46 UW-Eau Claire at Marshfield - Nursing
- 47 North Central Health Care
- 48 UW-Stevens Point - Health Sciences & Wellness Programs
- 49 UW-LaCrosse Public - Heath & Community Health Edu.
- 50 Medical College of Wisconsin
- 51 UW-Madison - Physician Assistant

### Government and Public Administration; Law, Public Safety, Corrections and Security

- 52 Marathon County Sheriff's Department
- 53 Northcentral Technical College - Public Safety - Fire
- 54 Wausau Fire Department
- 55 Department of Corrections - Lincoln Hills
- 56 Women's Community

### Arts, AV Technology & Communications

- 57 UW-Stevens Point School of Art & Design - Architecture, Graphic Design, & Fine Arts
- 58 UW-Oshkosh - Radio, TV, & Film
- 59 WSAW Channel 7

**DOWNSTAIRS TO MAIN FLOOR (SEE OTHER SIDE)**

Elev.

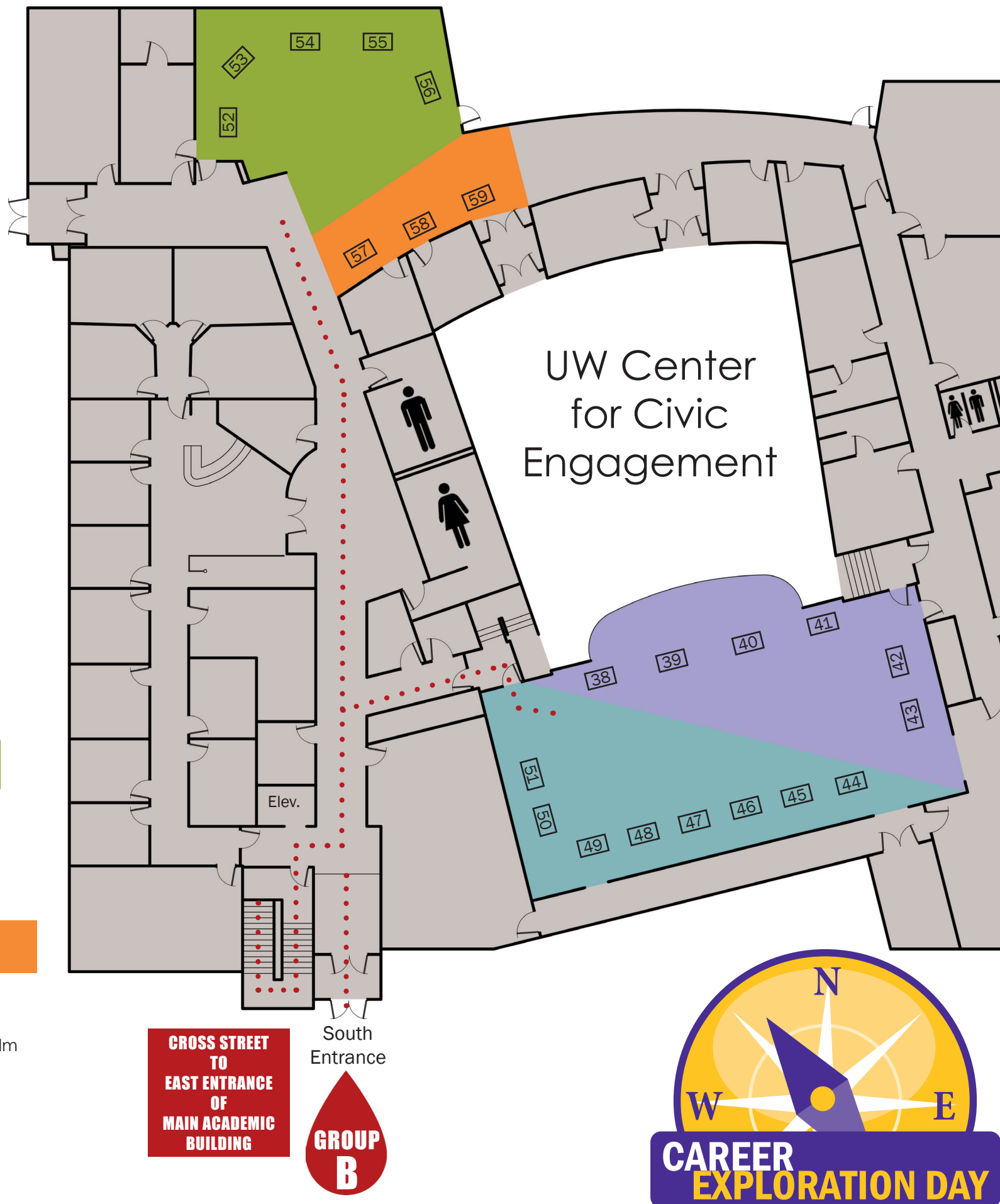

Elev.

South Entrance

**GROUP B**

**CROSS STREET TO EAST ENTRANCE OF MAIN ACADEMIC BUILDING**

