



NEALE HALL

ABOUT NEALE HALL

Neale Hall is a traditional-style residence hall that is located near the **DeBot Dining Center** as well as the businesses on Division Street. Neale Hall is within walking distance of **Marshfield Clinic Health System Champions Hall** and student parking lot P. Students are housed in a "scattered" room configuration; with restroom facilities available on each floor (restrooms are single-sexed).

Call Neale Hall

Phone: 715-346-3478

Send Mail to Neale

Student's name
Rm# Neale Hall
433 Isadore Street
Stevens Point, WI 54481



Great Campus Location



Music Practice Room



Elevator

ROOM DIMENSIONS AND FURNISHINGS

Double room occupancy with the provided furnishings:

- 2 beds (**frame** with a twin extra-long mattress)
- 2 **desks** with attached bookcase/hutch (desk lamp included)
- 2 desk chairs
- 2 **dressers**
- 2 closets
- 2 wastebaskets
- 2 mirrors

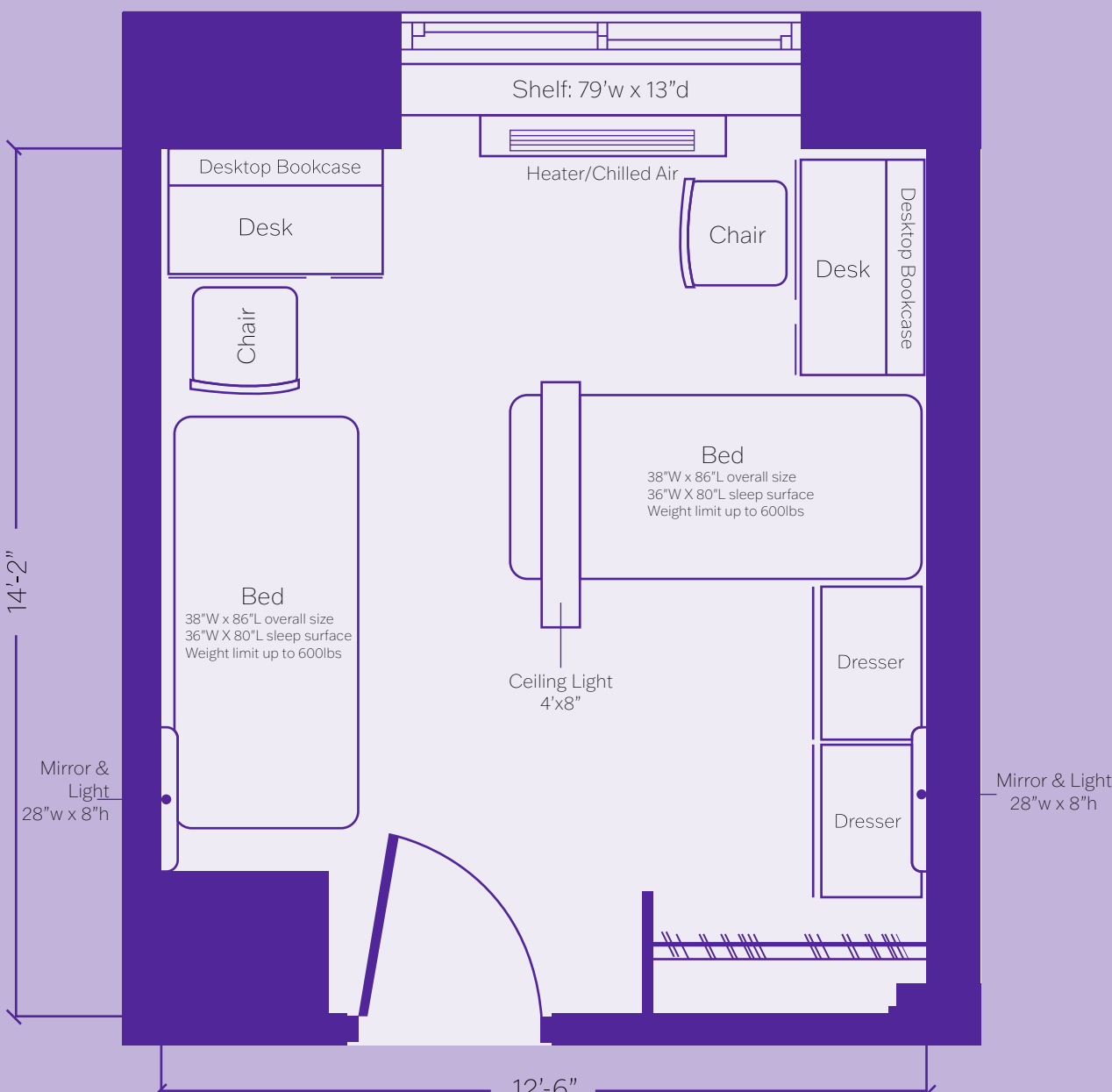
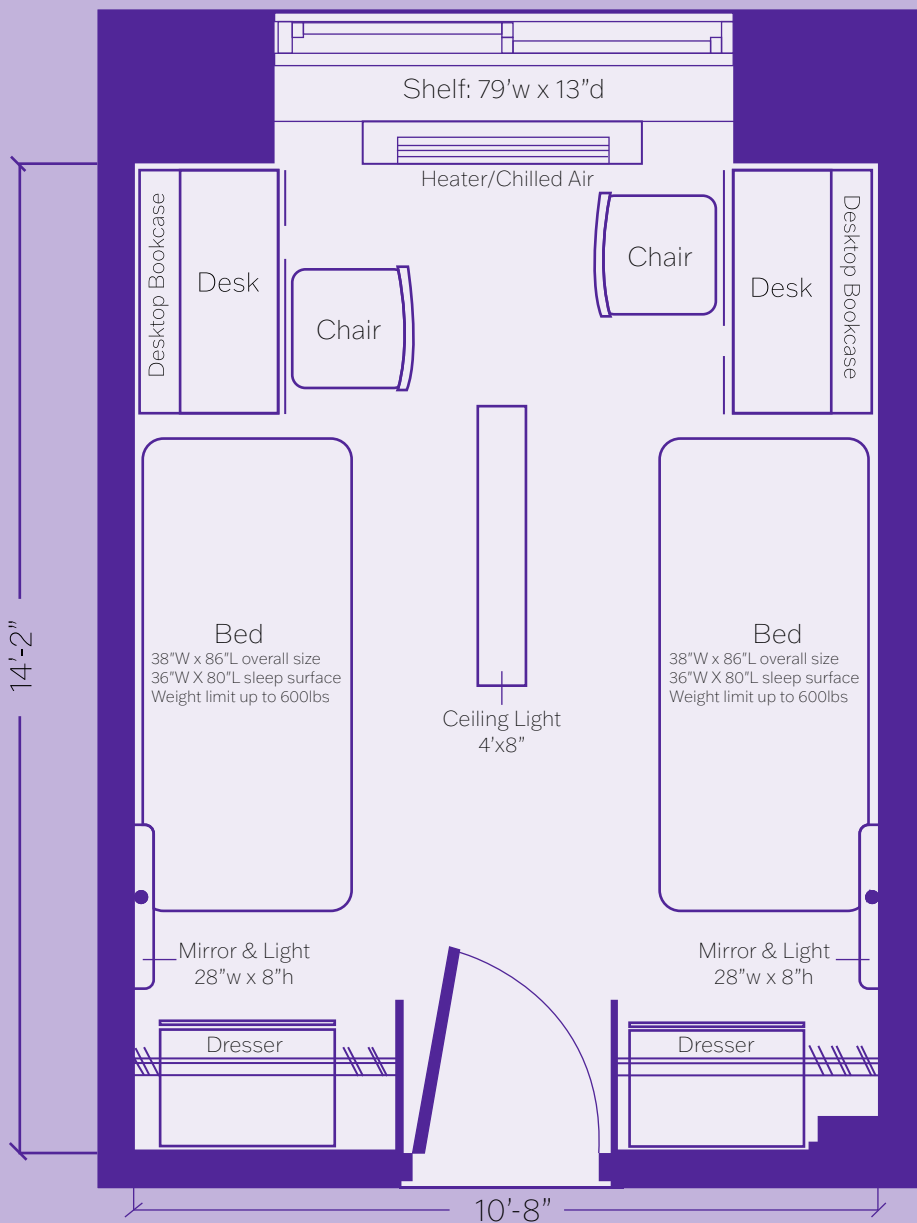

RESIDENCE HALL FEATURES

Room features:

- Air conditioning
- Temperature control
- WiFi connection
- Cable TV hookups
- SpectrumU Streaming



Computer Lab and Study Lounge



Full Laundry (Free to use!)

Basement features:

- Full laundry (free!)
- Study Lounge
- Computer lab
- Recreation/lounge area
- Music practice room
- Full kitchen
- Gender inclusive bathroom

Additional Features:

- Full kitchen on each floor
- Elevator

OSCAR W. NEALE

- Oscar Neale was hired by Stevens Point Normal School in 1915 to head the Rural Education Department.
- He was instrumental in establishing practice teaching for his students in both rural and city schools.
- During his first year at Stevens Point, he introduced a course in art appreciation.
- In 1929 President Herbert Hoover appointed him as a member of the White House Conference of Child Health.



HOUSING AND RESIDENCE LIFE



University of Wisconsin
Stevens Point

1108 Fremont St., Stevens Point, WI 54481
housing@uwsp.edu | 715-346-3511

