

Treehaven
W2540 Pickerel Creek Avenue
Tomahawk WI 54487

Phone: 715.453-4106 Fax: 715.453.1811
Website: www.uwsp.edu/cnr/treehaven
Email: Treehaven@uwsp.edu

Treehaven

Education and Conference Center



"where learning comes naturally"

Meeting Planner

Table of Contents

2...Mission	7-9...Use Fees
3...What is Treehaven?	10-12...Orientation
4...Description of Facilities	13...Vallier Classroom Center
5...Trailside Nature Shop	14...Classroom Center Map
6...How to get to Treehaven	15...Grounds Map

Treehaven

Mission

Treehaven is the Wisconsin center for integrating natural resources, education, management, research and recreation.



Treehaven Education and Conference Center is owned and operated as a field station by the University of Wisconsin-Stevens Point College of Natural Resources.

Treehaven's multipurpose, year-round design, flexible facilities and location provides a beautiful and unique setting for:

- Public workshops
- Conferences
- University courses
- Meetings
- Professional development
- Group facilitation skills training
- Educationally oriented seminars and in-services
- School environmental programs
- Elderhostels
- Public naturalist programs for youth and adults
- Public special events exploring natural, historical and cultural features of the Northwoods.

Treehaven consists of 1,400 acres of northern forest. Trails that can be enjoyed throughout the year lead to natural settings with an abundance of wildlife.

What is Treehaven?

Treehaven is a complete residential education and conference facility which blends beautifully into the landscape. Located between Rhinelander and Tomahawk, Wisconsin, Treehaven rests on a glacial ridge overlooking 1,400 acres of Great Lakes forest. Trails which can be enjoyed year-round venture into Pickerel and Pine Creek valleys where a diversity of plant and animal communities await exploration.

Treehaven is an ideal site for meetings and conferences, public workshops, programs focusing on natural history and/or outdoor skills, university courses, school programs and in-services, Elderhostels, naturalist programs, and public and private special events that both celebrate and educate. Treehaven welcomes the College of Natural Resources (CNR) every summer, serving as the hub of the CNR's summer session. Students majoring in natural resources attend one of two six-week sessions, participating in field-oriented courses in wildlife, forestry, soils and aquatics.

The aroma of delicious food will lead you toward the Irving L. Young Lodge; home of the Bear Track Lounge, Osprey Nest nature library, and the beautiful WinterBerry Dining Room. The Vallier Classroom Center is well-equipped for workshops, conferences and classes. Its flexibility in design works well for large assemblies or intimate gatherings. The Okray living centers, Fern Young Cottage, and the new White Pine Lodge offer comfortable lodging for 126 people.

Treehaven is the result of a gift by Dory and Jacque Vallier and other generous donors. Their donations of land and financial support to the University of Wisconsin-Stevens Point Foundation created Treehaven as a unique environmental education and conference facility.

Description of facilities

WinterBerry Dining Room

- Dining for groups of up to 60-70 with additional seating available in an adjoining room.
- A panoramic view of the scenic Harrison Hills.
- Native stone fireplace offering cozy and intimate dining.
- Special menu choices include upscale dining, vegetarian and heart healthy options.
- Prices are inclusive (entrée, salad/vegetable, dessert, beverage).
- Appetizers and hors d'oeuvres available at extra cost.

Bear Track Lounge (not available for scheduled exclusive use)

- Cash bar available upon request.
- Piano, TV/VCR, pool table, foosball table, and electronic darts.
- Laundry and vending machines in adjoining rooms.
- Native stone fireplace available for guest use.

Osprey Nest

- Nature library, quiet lounge and small group meeting space lofted above WinterBerry Dining Room.
- Native stone fireplace available for guest use.

Vallier Classroom Center

- William Sylvester Auditorium features elevated stage, projection facilities and equipment, sync-dissolve equipment for slide presentations, remote controlled lighting, sound system, lectern, and listening aids for hearing impaired guests.
- Five meeting rooms for small groups up to 15 each.
- PC computer lab with internet access, LCD and overhead projectors, screens and slide projectors available.
- The Trailside Nature Shop offers a varied and unique shopping experience for guests.
- Access to wireless network – contact office for log-in information.

White Pine Lodge – 14 person capacity

- Four carpeted bedrooms, each with private bath, bed(s), closets, and phone.
- Two common living areas and kitchenette.
- Linens provided (includes sheets, pillowcases, two towels/one washcloth)

Okray Living Centers – NOT AVAILABLE Sept 1, 2009 – May 1, 2010

- Will be under construction during this time.
- New facility to have:
 - Up to 4 persons per room with private bathroom
 - Each Bathroom includes toilet, shower and sink.
 - Two studio apartments and two study lounges

Fern Young Cottage – 20 person capacity

- Five carpeted bedrooms with 2 bunk beds per room, chests and closets.
- Three private baths, common living area, TV/VCR, kitchen and laundry.
- Linens provided (includes sheets, pillowcases, two towels/one washcloth)

A “No Camping” policy is in effect on the site. This includes tents, motor homes and campers.

Treehaven Trailside Nature Shop



Educational items and exclusive outdoor apparel

- Music
- Books
- Field Guides
- Educational items
- Nature apparel
- Bird houses
- Decorative items
- Animal puppets
- Snowshoe items
- AND MORE!

Where:

Vallier Classroom Center
Room 207

Open:

For scheduled programs or as
requested by guests.

How to get to Treehaven

Mileage from. . .

Appleton	134
Chicago	320
Green Bay	130
LaCrosse	200
Madison	200
Milwaukee	230
Minneapolis/St. Paul	210

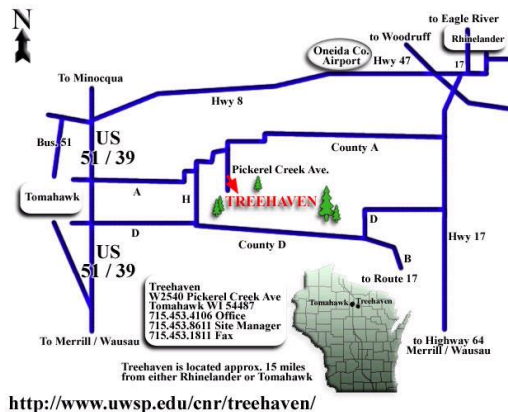

<http://www.uwsp.edu/cnr/treehaven/>

Air Travel

- Central Wisconsin Airport – Mosinee, WI – connecting from Chicago O’Hare Airport - currently served by United, Northwest and Midwest
- Rhinelander/Oneida County Airport (RHI) – connecting from Minneapolis - Northwest Airlink - 800.225.2525
- Shuttle service between the Rhinelander Airport and Treehaven can be arranged by calling Treehaven - 715.453.4106.

Car rental

CWA

Avis 800.831.2847
National 800.227.7368
Hertz 800.654.3131

Rhinelander

Avis 715.365.3436
National 715.365.3430

Use Fees

All fees Subject to change

Reservation/deposit procedure

- Call Treehaven’s registrar at 715.453.4106 for available dates for your visit. The registrar will explain the reservation and deposit procedure.
- Your reservation is secure when the deposit is received.
- Confirmation of food service and lodging needs is required two weeks prior to the visit.
- Minimum billing is based on these figures.

(Note: With prior approval, groups of less than 80 may reserve exclusive use of the Treehaven facility for an extra fee. Contact Treehaven office for current rates. This does not include use of White Pine Lodge.)

Lodging Fees

- Linen service is included with your reservation. (2 sheets, pillowcase, wool blanket, 2 towels, washcloth & bar of soap)
- Children under the age of 5 stay at no charge.
- Special off-season rates of \$50.00 per night for up to 4 per room are in effect during November and December in Okray Living Center.
- Special rates are available for school groups (K-12).

Okray Living Centers

Will be under renovation from September 1, 2009- May 1, 2010. We apologize for any inconvenience, however we believe you will be very excited with the outcome! Each room will still house up to 4 people but will now have its own bathroom which will include a toilet, sink and shower! Rates after May 2010 are yet to be determined!

Fern Young Cottage & White Pine Lodge

Single	\$40/room = \$40/persons	Total Beds: 9-11
Double	\$50/room = \$25/persons	Total Beds: 18-22
3-4	\$60/room = \$15/persons	Total Beds: 34-40

Fern Young Capacity: 20 persons

(Features 3 shared bathroom facilities, kitchen, lounge area with television, laundry, deck and patio)

White Pine Lodge Capacity: 14persons

(Features private bath off room, kitchenette, living area, and deck off each unit)

Use Fees - continued

Program Fees

- Guided nature hikes and related activities - \$5.00/hour per person per naturalist. Minimum \$25.00 per hour per group. Maximum 20 people per group.
- On-site school group day programs available -\$13.00 per person (without lunch).
- Please contact Treehaven to set up a full day or residential natural resource/environment/education program for your group. Prices will be quoted at that time

Facility Use Fee

- \$5.00 per person/day – includes use of scheduled meeting rooms, AV equipment, lounge, computer room, coffee, tea, dispenser soda and trail pass.

Food Service - Menu Options

	<u>Standard</u>	<u>Upscale</u>
• Breakfast	Hot Entrée Cereal Juices/beverage Toast/rolls	Hot Entrée (choice) Cereal Fruit Juices/beverage Breakfast breads
• Lunch	Soup Entrée Cookies Beverage	Soup Salad bar Entrée Cookies/bars Beverage
• Dinner	Salad bar Entrée Side dishes Rolls Dessert Beverage	Salad bar Soup Entrée (prime rib, filet mignon, seafood) Rolls Dessert Beverage

Food Service – Costs

	<u>Standard</u>	<u>Upscale</u>
• Breakfast	\$7.50/person	\$8.50/person
• Brunch	\$9.50/person	
• Lunch	\$7.50/person	\$9.50/person
• Dinner	\$9.75/person	MKT

(All meals inclusive of drinks and desserts.)

(Children under the age of 5 dine at no charge.)

If you have any special requests or needs, please contact Treehaven.

- Break service: Danish/donuts/cookies/fruit - \$2.00-3.75/person
- Soda in cans - \$.75 each
- Cheese/crackers, fruit/bread trays, specialty hors d'oeuvres, and host or no-host bars are available for an additional charge.

Food Service - Meal Times

Standard start times - may be scheduled between:

- Breakfast - 8:00 a.m. - 9:00 a.m.
- Lunch - 12:00 p.m. - 1:00 p.m.
- Dinner - 5:00 p.m. - 6:00 p.m.

Earlier or later start times may be pre-arranged and subject to higher fees.

Alcohol Policy

- A cash bar is available upon request prior to your group's arrival.
- Alcohol is **only allowed** in private rooms, **NOT** in public places.

Smoking Policy

- Smoking is permitted outdoors only and at least 50 feet from all building entryways!

Pets

- No pets are allowed on the site, either indoors or outside.
- Please advise your participants of this restriction so they can arrange to board their pets.

Orientation

Check-in and Check-out procedures and times

- Check-in is 3:00 p.m.
- Check-out is 12:00 noon.
- Clear personal belongings from the living centers by 12:00 noon on the day of departure. Guests are welcome to secure items in their cars and continue to utilize Treehaven's trails or facilities for the remainder of that day.
- When rooms are available, groups needing access to living center rooms past 12:00 noon, but not staying an additional night, will be charged ½ of the daily lodging rate.

Phone/Internet/Email Access

- For public use, a phone is available in Room 200A and 105/107, Vallier Classroom Center.
- Internet and email can be accessed in the computer lab located in Room #105/107, Classroom Center, with arrangements in advance.
- Computer Lab and wireless available, contact main office for access.

Treehaven Trailside Nature Shop

- Located in Room #207, Vallier Classroom Center, offering educational items and exclusive outdoor apparel.
- The Shop will be open during the lunch hours of the visiting groups, Monday through Friday, and Saturday as requested.
- Check with the office to have the store open at other times.

Linens

- Towels, wash cloths, bed linens, soap, pillows and wool blankets are provided. Towels can be changed by contacting the main office.
- At check-out, please place soiled linen on the floor, and leave mattress cover on the bed.

Mail Service

- An outgoing mail box is located on the left side of the mailboxes, on the upper level of the Vallier Classroom Center.
- Deposit mail by 10:00 a.m.
- Incoming mail arrives early afternoon and can be picked up in the main office.
- Stamps are for sale in the office.

Incoming Messages

- Messages will be relayed from the main office during business hours.
- After-hours office voice mail is picked up the following morning, and delivered at that time.

Accessibility

- An outside ramp connects upper and lower levels of the Young Lodge (WinterBerry Dining Room and Bear Track Lounge) and Vallier Classroom Center with Okray Living Center A.

Restrooms

- Located in the Young Lodge (both levels) and the lower level of the Vallier Classroom Center.

Laundry Facilities

- Coin-operated washers and dryers are located just off the common lounge on the lower level of the Young Lodge.
- Cost per load \$1.25
- Laundry soap is available for purchase in the Trailside Shop.

Vending Machines

- Located in room next to laundry, offering a variety of soda and snacks.
- Soda machines are also located on lower level of Vallier Classroom Center and Living Centers.

BearTrack Lounge

- Contains a native stone fireplace, piano, TV, foosball table, and electronic dartboard.
- Cash bar is available upon request, but the lounge cannot be reserved for meetings.

Copier Usage

- Available for those paying the daily site use fee, copier (\$.10/copy), printer, and twelve stations with high-speed internet.
- Check with main office for any necessary codes.

Outdoor Deck

- Built-in seating on the outdoor deck behind the lodge has been expanded to accommodate outdoor classes, receptions and exhibits.

Orientation - continued

Osprey Nest Library/Lounge

- Located in the loft above the WinterBerry Dining Room for those who desire reading, quiet entertainment (board games and puzzles available), or would like to browse the nature library.

Trails

- Trail maps are located in brochure racks outside the main office or in the BearTrack Lounge.
- Ten miles of trails are maintained for hiking, snowshoeing or crosscountry skiing.
- Motorized vehicles and mountain bikes are prohibited on the trails.

Recreational Areas on Grounds

- Fire ring and gazebo near Dragonfly Pond.
- Volleyball courts, basketball hoops, horseshoe pits, open playing field.
- Hiking trails, cross-country ski trails, separate snowshoe trails.
- Recreational lounge in main lodge.

Recreational Items Available for extra fee.

- Bats, softballs, soccer balls, footballs, basketballs, horseshoes, volleyballs, board games, pool, foosball, darts, snowshoes, skis.

Naturalist Services

- Naturalist services, guided nature walks, cross-country ski and snowshoe tours.
- Environmental education workshops and other special programs are available for a nominal fee with prior arrangements. (See Program Fees.)

Weather Shelter

- In the event of a tornado warning or weather emergency, shelters are located in:
 - Restrooms on the lower level of Vallier Classroom Center.
 - Showers in lower level of living centers.

Area Attractions

- Ice Age Trail
- Logging Museum
- Cross-country skiing
- Biking
- Fishing

Vallier Classroom Center

Upper Level	Set-up of Room	# of people	Sink
200A	Classroom	20	No
200B	Classroom	20	No
200A/200B	Assembly	100	No
201	Classroom	16	No
203	Classroom	16	Yes
201/203	Assembly	50	Yes
205	Classroom	16	Yes

Lower Level	Set-up of Room	# of people	Sink
109	Classroom	16	No
105/107	Computer Lab	24	No
	William Sylvester Auditorium		No
	Assembly	120	
	Classroom	80	

UW-Stevens Point provides equal opportunities in employment and programming. Please advise at time of registration if you need reasonable accommodations for a disability. Requests will be confidential.

Phone - 715.453.4106

Fax – 715.453.1811

Email – treehaven@uwsp.edu

Website - www.uwsp.edu/cnr/treehaven

Classroom Center Map

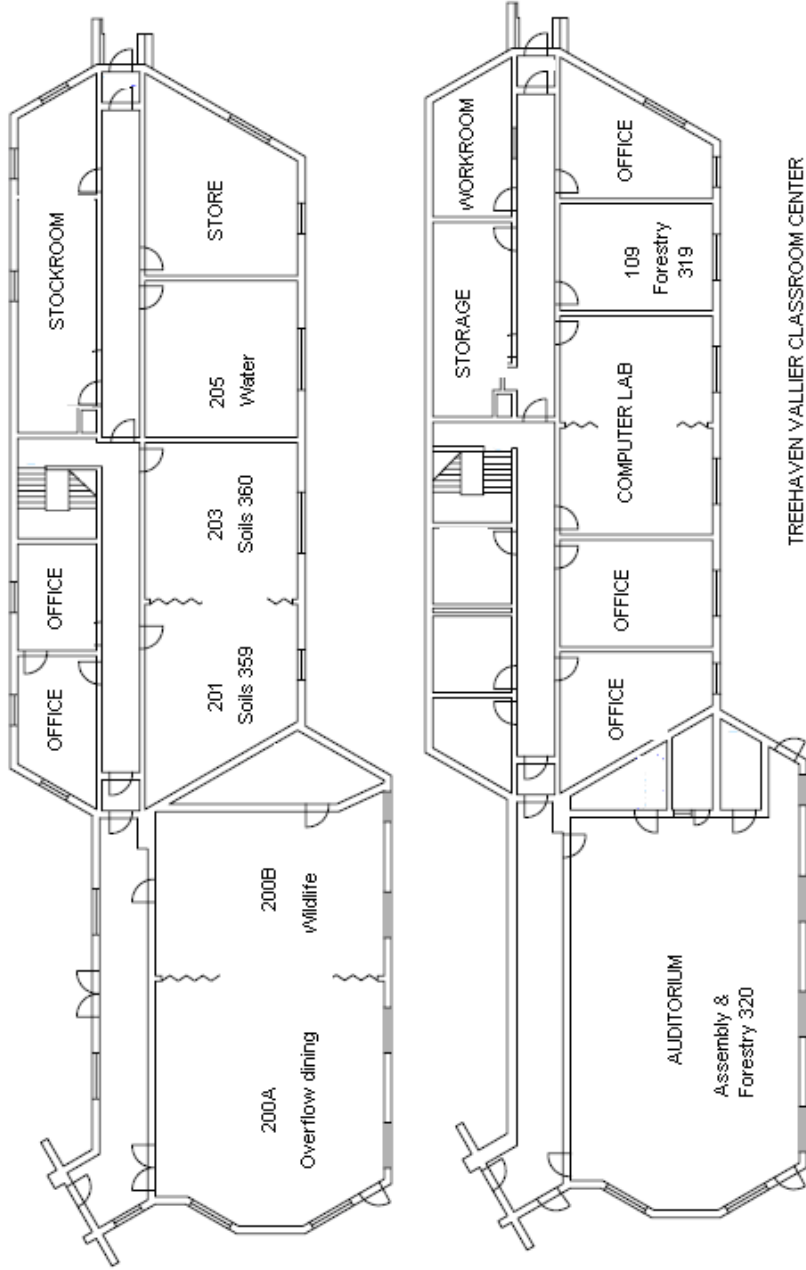

Treehaven Grounds Map

